

FORM NO. 1.

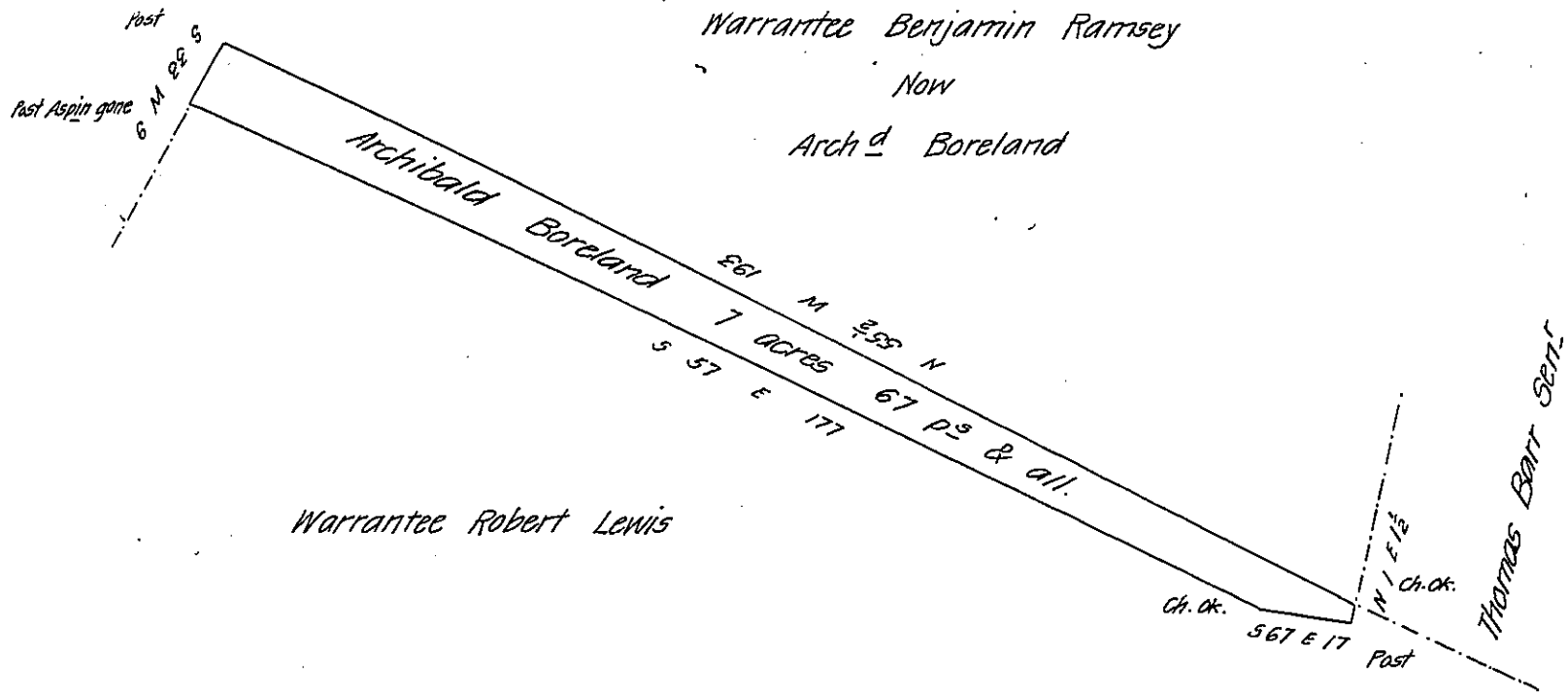

Surveyed February 4th A.D. 1858 for Archibald Boreland the above described land containing seven acres and sixty seven perches and allowance of six per cent for Roads &c. a part of which has been improved for some time Situate in Rayne township Indiana County adjoining lands of Benjamin Ramsey & Robert Lewis By warrant of January 27th 1858 David Peelor

To John Rowe Esq County Surveyor of Indiana County
Surveyor General

Samuel Adams & Christopher Boreland guardian of the minor heirs of John F. Cooper dec^d Caveats the above survey alledging that the above survey belongs to the tract of land warranted in the name of Robert Lewis

David Peelor C.S.

IN TESTIMONY that the above is a copy of the original remaining on file in the Department of Internal Affairs of Pennsylvania, made conformably to an Act of Assembly approved the 16th day of February 1833, I have hereunto set my hand and caused the Seal of said Department to be affixed at Harrisburg, this eighteenth day of January 1908

Henry Houck
Secretary of Internal Affairs.